

OTC ASIA 2014

25 - 28 March 2014

KUALA LUMPUR CONVENTION CENTRE Exhibition Hall 1&2 (Ground Level)

EXHIBITION HALL 2

EXHIBITION HALL 1

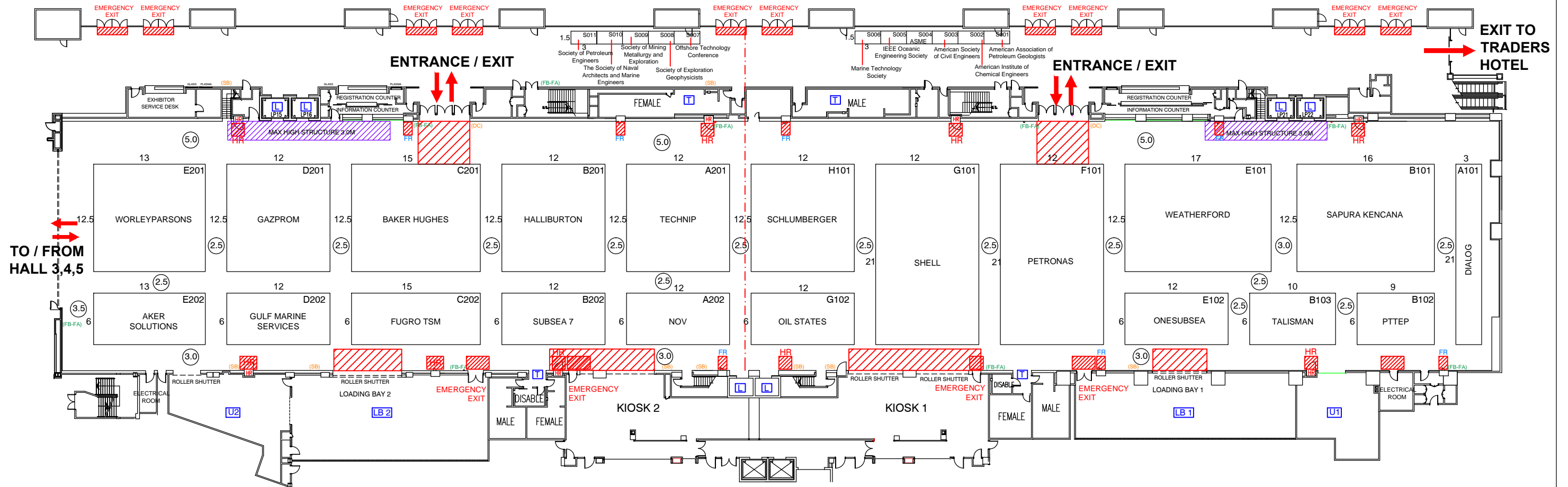

KLCC RULES & REGULATIONS :

LEGEND :		
FR	FIRE EXTINGUISHER	NO BUILD UP AREA
HR	HOSE REEL	DC DOOR CONTROLLER
FA	FIRE ALARM	SB SUIS BOARD
FB	FIRE BREAK GLASS	BALCONY
RS	ROLLER SHUTTER (5m W x 6m H)	WEST WING CAFE AREA

* THIS FLOOR PLAN IS SUBJECT TO KUALA LUMPUR CONVENTIONCENTRE APPROVAL

PROJECT / EXHIBITION / SHOW	SHOW PERIOD	CLIENT	PERSON-IN-CHARGE	REMARKS	AMENDMENT	DATE	DRAWING TITLE
OTC ASIA 2014	25 - 28 March 2014	SPE	MANDY SIM		R36	6.1.2014	LAYOUT PLAN
					R37	10.1.2014	
					R38	23.1.2014	
VENUE / ADDRESS	CITY / COUNTRY	CLIENT APPROVED	DATE	DRAWN BY	DATE		PROJECT NUMBER
KLCC, Exhibition Hall 1&2	MALAYSIA		20.2.2014	MAIZA	13.3.2012		EPC/110/612-000
				CHECKED BY	DATE		DRAWING NUMBER
				ZES	20.2.2014		EPC/001-OA-R42



Total Brand Activation

This design is copyright of Pico International (M) Sdn Bhd which cannot be reproduced or modified. Any unauthorised use in part or in whole is subject to prosecution.

This drawing is subject to modification to suit construction purposes

OTC ASIA 2014

25 - 28 March 2014

KUALA LUMPUR CONVENTION CENTRE Exhibition Hall 3,4&5 (Ground Level)

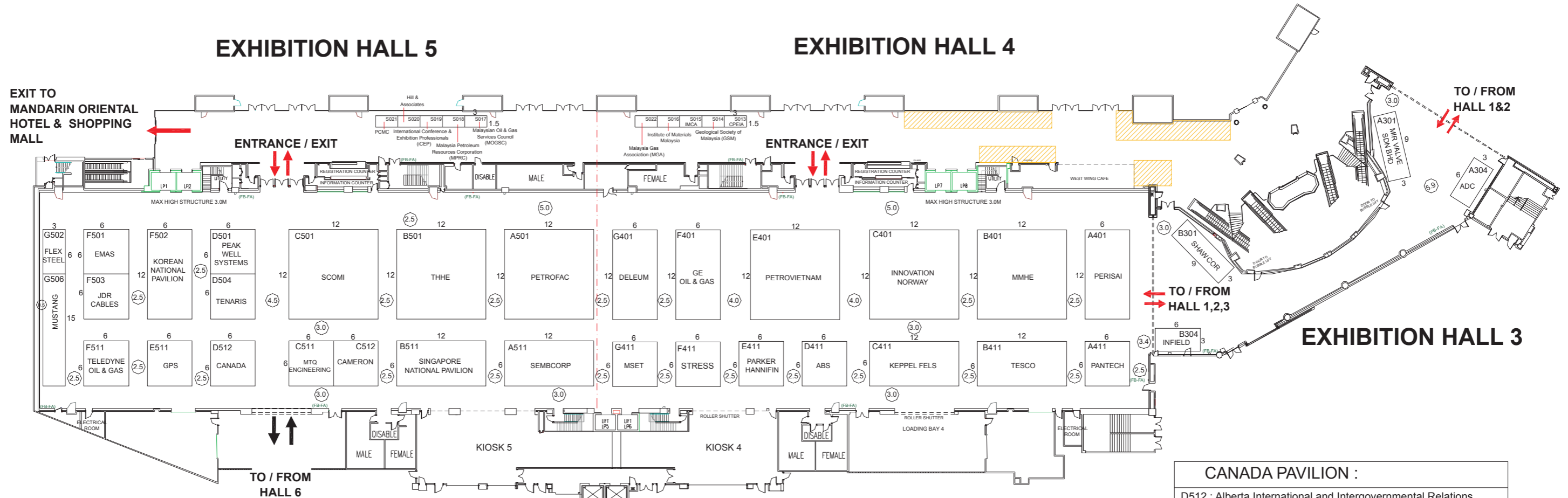

- KOREA NATIONAL PAVILION :**
- F502-1 : OSGC
 - F502-2 : Hoseung Enterprise
 - F502-3 : Steel Flower
 - F502-4 : Mirae Winch
 - F502-5 : DMC
 - F502-6 : Cytroniq
 - F502-7 : Donghwa TCA
 - F502-8 : Daechun
 - F502-9 : Tank Tech
 - F502-10 : Oriental Precision & Engineering
 - F502-11 : Elscorn
 - F502-12 : Mt.H Control Valve
 - F502-13 : Staco
 - F502-14 : Donghwa Entec
 - F502-15 : Busan Marine Equipment Association

- NORWAY NATIONAL PAVILION :**
- C401 : Innovation Norway
 - C401-1 : Autronica Fire and Security AS
 - C401-2 : Det Norske Veritas AS Sdn. Bhd.
 - C401-3 : BW Offshor
 - C401-4 : Bandak Group
 - C401-5 : Frigstad Engineering
 - C401-6 : Macgregor
 - C401-7 : OCTIO AS
 - C401-8 : Wilhelmsen Ship Management
 - C401-9 : Jotun (Malaysia) Sdn Bhd
 - C401-10 : Tamrotor Marine Compressors AS

- CANADA PAVILION :**
- D512 : Alberta International and Intergovernmental Relations
 - D512 : Nova Scotia Department of Energy
 - D512 : High Commission of Canada
 - D512 : Master Flo Valve

- SINGAPORE NATIONAL PAVILION :**
- B511-1 : KM Kinley Marketing Pte Ltd
 - B511-2 : AX Coleman Pte Ltd
 - B511-3 : Kim Heng Marine & Oilfield Pte Ltd
 - B511-4 : Kheng Cheong Co Pte Ltd
 - B511-5 : TEHO International Inc Ltd
 - B511-6 : Association of Singapore Marine Industries (ASMI)
 - B511-7 : Marshall Cavendish Business Information Pte Ltd
 - B511-8 : Applied Engineering Pte Ltd
 - B511-9 : KTL Offshore Pte Ltd

KLCC RULES & REGULATIONS :

LEGEND :	
FIRE EXTINGUISHER	NO BUILD UP AREA
HOSE REEL	DOOR CONTROLLER
FA FIRE ALARM	SUIS BOARD
FB FIRE BREAK GLASS	BALCONY
ROLLER SHUTTER (5m W x 6m H)	WEST WING CAFE AREA

*** THIS FLOOR PLAN IS SUBJECT TO KUALA LUMPUR CONVENTIONCENTRE APPROVAL**

PROJECT / EXHIBITION / SHOW OTC ASIA 2014	SHOW PERIOD 25 - 28 March 2014	CLIENT SPE	 Total Brand Activation This design is copyright of Pico International (M) Sdn Bhd which cannot be reproduced or modified. Any unauthorised use in part or in whole is subject to prosecution.	PERSON-IN-CHARGE MANDY SIM	REMARKS	AMENDMENT	DATE	DRAWING TITLE LAYOUT PLAN	
VENUE / ADDRESS KLCC, Exhibition Hall 3,4&5	CITY / COUNTRY MALAYSIA	CLIENT APPROVED		DATE 27.2.2014		SCALE -	R38		23.1.2014
			This drawing is subject to modification to suit construction purposes	DRAWN BY MAIZA	DATE 13.3.2012	R39	27.1.2014	PROJECT NUMBER EPC/110/612-000	
				CHECKED BY ZES	DATE 27.2.2014	R40	7.2.2014		
						R41	12.2.2014		DRAWING NUMBER EPC/002-OA-R44
						R42	20.2.2014		
					R43	26.2.2014			
					R44	27.2.2014			

OTC ASIA 2014

25 - 28 March 2014

KUALA LUMPUR CONVENTION CENTRE Exhibition Hall 6 (Ground Level)

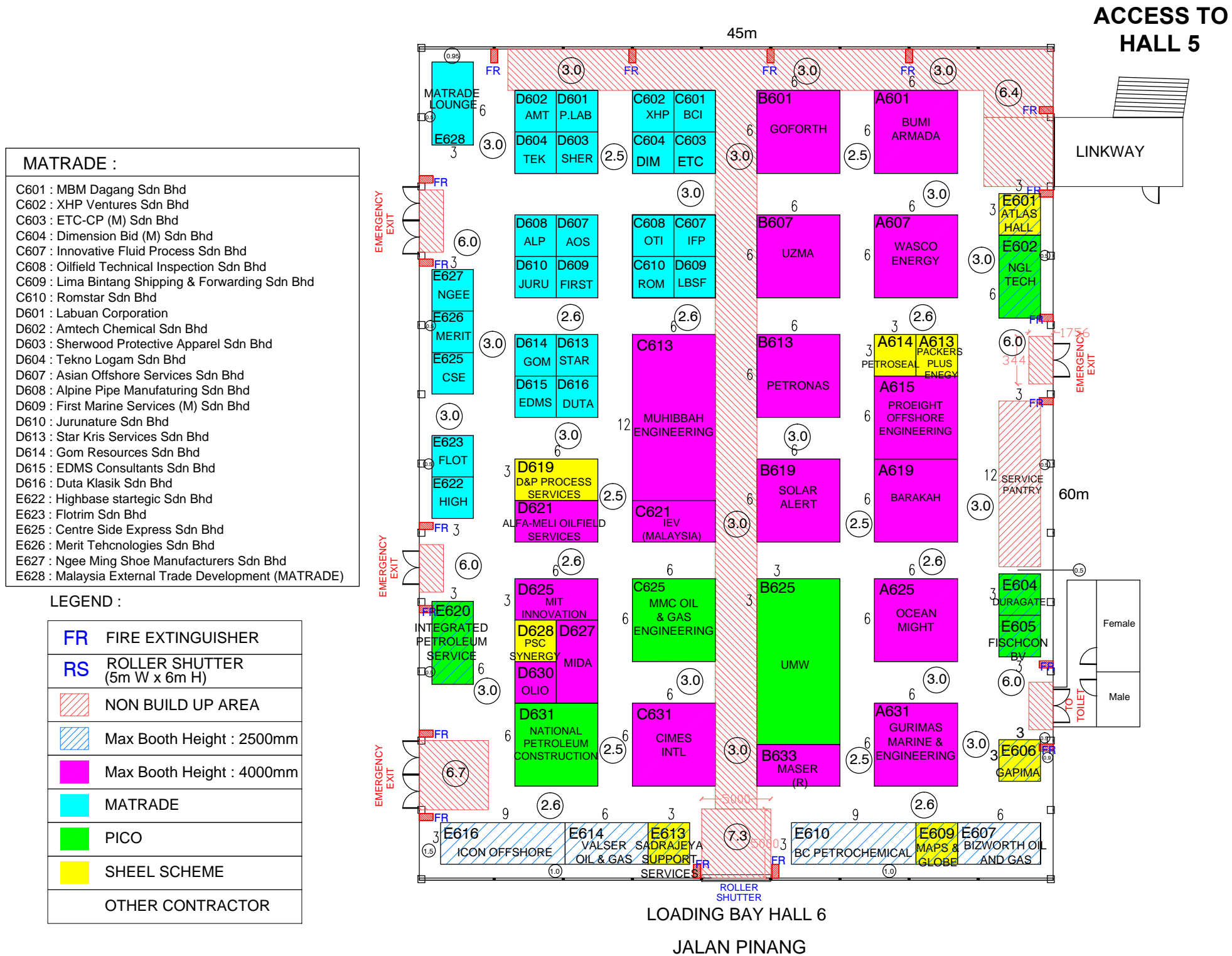

* THIS FLOOR PLAN IS SUBJECT TO KUALA LUMPUR CONVENTION CENTRE APPROVAL

PROJECT / EXHIBITION / SHOW	SHOW PERIOD	CLIENT	PERSON-IN-CHARGE	REMARKS	AMENDMENT	DATE	DRAWING TITLE
OTC ASIA 2014	25 - 28 March 2014	SPE	MANDY SIM		R39	7.2.2014	LAYOUT PLAN
					R40	7.2.2014	
					R41	12.2.2014	
VENUE / ADDRESS	CITY / COUNTRY	CLIENT APPROVED	DATE	DRAWN BY	DATE		PROJECT NUMBER
KLCC, Exhibition Hall 6	MALAYSIA		12.3.2014	MAIZA	15.8.2013		EPC/110/612-000
				CHECKED BY	DATE		DRAWING NUMBER
				ZES	12.3.2014		EPC/003-OA-R45



This design is copyright of Pico International (M) Sdn Bhd which cannot be reproduced or modified. Any unauthorised use in part or in whole is subject to prosecution.

This drawing is subject to modification to suit construction purposes

OTC ASIA 2014

25 - 28 March 2014

KUALA LUMPUR CONVENTION CENTRE

Exhibition Hall 7 (Level 3)

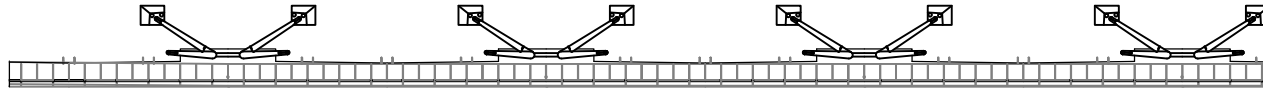

HOLLAND NATIONAL PAVILION :
 B701 : CSI Control Systems/ Winmag/ Holland Marine Equipment
 B702 : SoluForce / PipeLife Nederland BV
 B703 : Bierens Machinefabrieken
 B704 : Van Leusden BV
 B705 : NL Lounge/Oliveire Hydro Marine & Shipping
 B706 : TKF/ HMSA

US NATIONAL PAVILION :
 C701 : American Completion Tools, Inc.
 C702 : Wilkens Weather Technologies, LP
 C703 : Klinge Corporation
 C704 : Sherwin-Williams
 C705 : Pelican Products, Inc.
 C706 : TAM International
 C707 : Kallman Worldwide Inc.
 C708 : Martin Engineering
 C709 : American Petroleum Institute (API) - Washington
 C710 : G.A.S.
 C711 : GeoForce, Inc.
 C712 : Freemyer Industrial Pressure LP.
 C713 : DrawWorks, L.P.
 C714 : New Tech Systems

AUSTRALIA NATIONAL PAVILION :
 E701 : BSL Containers Limited
 E702 : Hawke Transit System
 E703 : Inflatable Packers
 E704 : Aussie Fluid Power
 E705 : Viking Seatech (S) Pte Ltd
 E706 : American Chamber of Commerce in Australia (AMCHAM)
 E707 : Australian Government Sponsored Lounge
 E708 : Constructive Media
 E709 : Hydratight
 E710 : Cortland Company

CHINA NATIONAL PAVILION :
 D701 : Wenhzhou Huahai Sealing Co., Ltd. / Asian Star Anchor Chain Co., Ltd.
 D702 : Ningbo Orient Wires & Cables Co., Ltd
 D703 : HuaDong Valve Company Limited
 D704 : Tianjin De-Sail Machinery Equipment Co., Ltd.
 D705 : ChangSha Carrie Heavy Industry Machinery Co., Ltd.
 D706 : FRValve (Suzhou) Corp. Ltd.
 D711 : ZhuZhou Seed Cemented Carbide Technology Co., Ltd
 D712 : PanZhiHua HengYuan Petroche Co. Ltd
 D713 : GOWell Petroleum Equipment Co., Ltd.
 D714 : HongHua Group
 D715 : TianJin HuiLiTong Steel Tube Co., Ltd.

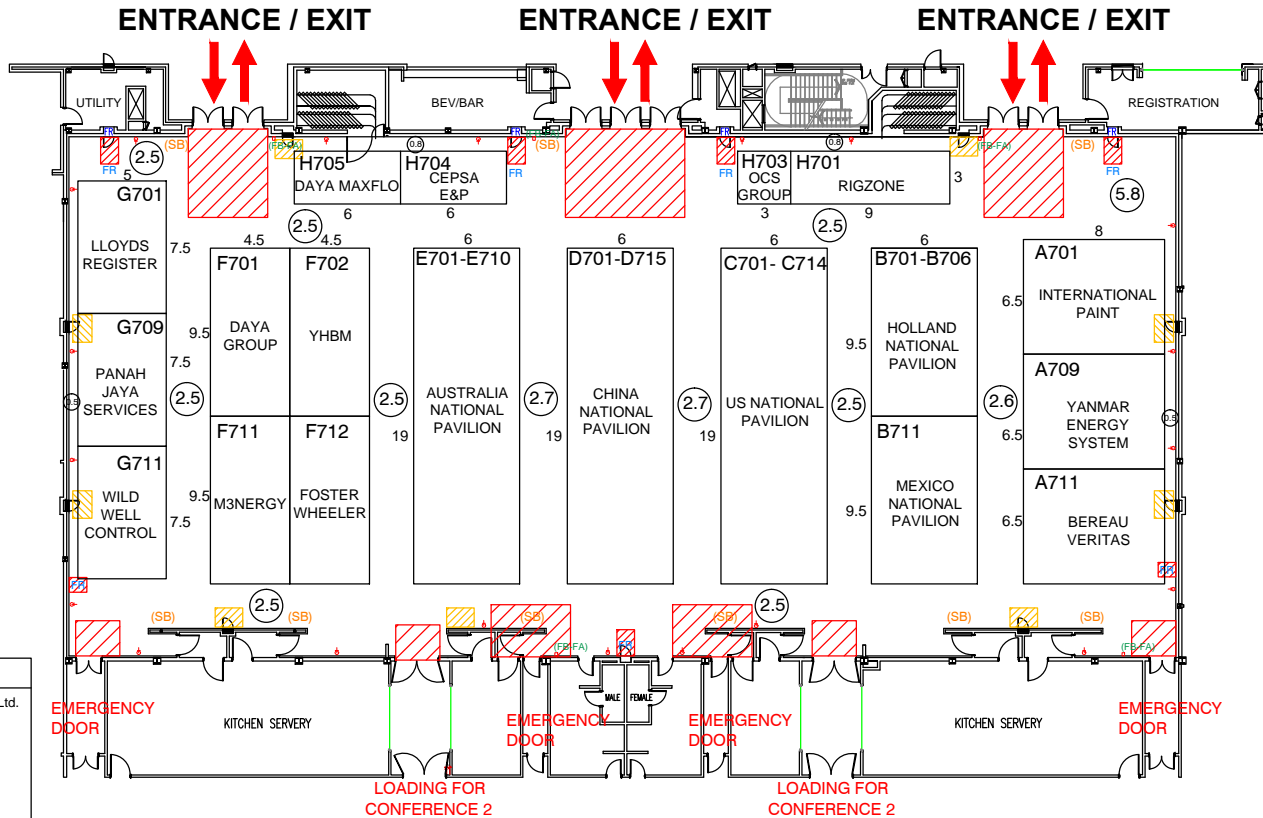

KLCC RULES & REGULATIONS :

LEGEND :	
FR	FIRE EXTINGUISHER
HR	HOSE REEL
FA	FIRE ALARM
FB	FIRE BREAK GLASS
[Red Hatched]	NON BUILD UP AREA
DC	SUIS BOARD
SB	DOOR CONTROLLER
[Blue Hatched]	BALCONY

* THIS FLOOR PLAN IS SUBJECT TO KUALA LUMPUR CONVENTIONCENTRE APPROVAL

PROJECT / EXHIBITION / SHOW	SHOW PERIOD	CLIENT	PERSON-IN-CHARGE	REMARKS	AMENDMENT	DATE	DRAWING TITLE
OTC ASIA 2014	25 - 28 March 2014	SPE	MANDY SIM		R39	27.1.2014	LAYOUT PLAN
					R40	7.2.2014	
					R41	12.2.2014	
VENUE / ADDRESS	CITY / COUNTRY	CLIENT APPROVED	DATE	DRAWN BY	DATE		PROJECT NUMBER
KLCC, Exhibition Hall 7 (Conference Halls 1-3, Level 3)	MALAYSIA		5.3.2014	MAIZA	13.3.2012		EPC/110/612-000
				CHECKED BY	DATE		DRAWING NUMBER
				ZES	5.3.2014		EPC/004-OA-R45

pico
Total Brand Activation

This design is copyright of Pico International (M) Sdn Bhd which cannot be reproduced or modified. Any unauthorised use in part or in whole is subject to prosecution.

This drawing is subject to modification to suit construction purposes